

Wildflowers of Texoma Decorative Artists

April, 2010

Issue 4



Sharon Says

Well, we are off and running for the New Year. I can't believe it is already going to be April. Thanks to Lisa for teaching us the mitten. Those were cute. I still need to finish mine.

Since I am late with this letter, I can now mention the seminar. It went very well. I think everybody enjoyed the rose class, even though we still have a lot to learn about a rose. Ginger was a very good teacher and had lots of patience with us. I think it is always good to take from these teachers that have so much knowledge about painting (since I don't). I couldn't believe after the mess I made of that rose she could fix it. I am going to practice more on that rose.

Thanks to Carol and Doris for everything they did for the seminar. Ginger stayed with Carol and had to get her back to the airport in the SNOW (can you believe it). I understand Doris was also helping her with that. As I write this I have

but I hope they made it all right. We went to Plano to a music thing Sunday and cars were off the road everywhere.

Thanks to everyone who brought breakfast stuff for the seminar and to Carol for bringing the coffee pot. Everything was very good. I found a new recipe for my Atkins diet from what Lisa brought. Its called jalapeno fudge and it was very good.

We are going to meet at the Willows this month and voting whether or not we want to continue meetings there. I think everyone liked it and it's free so that's a plus. Everybody be sure and come to the meeting.

Hope everyone is getting packed up for Nationals. That is going to be fun time.

Sharon

Inside this issue

Please Remember	2
Happy Birthday	2
Treasurer's Report	2
Directions and map	3
Minutes	4
Workshops and Paint ins	5
Chapter website	5
April paint in	5
April pattern	6
Ways and Means	7
Seminar	8
2010 Conventions	8
Board of Directors	9
Calendar of Interest	9

Paint in - April 13
Angels Keep Me Balanced
Checkbook Insert

Please remember

Jean Bentley - ongoing medical

Ann Lovelace - ongoing medical

Elder caregivers: LaDeen Betts, Janice Marshall, Sheri Merriman

Marge Abernathy's husband Frank - medical

Bette Thompson's husband Cliff' - lung cancer

Sue Caylor's twin brother, Robert Bentley (terminal esophagus cancer), sister and daughter, medical

Please let me know any updates to the above so that I can include in the next newsletter. If I have missed anyone, my sincere apologies as it is not intentional; just my not knowing about everyone.



Happy Birthday

April

- 01 - Louise Gandert
- 25 - Ann Lovelace
- 28 - Shirley Colgrove



Treasurer's Report



Balance 2/10/10-----	\$5544.16
Expenses	
Cell Phone Holders (Chapter Marketplace)	\$28.86
Final payment for seminar	\$1062.96
Income/	
Edwards Seminar	\$180.00
Ending Balance for March	\$4632.34

ATTENTION

Our April paint in will be held at the Willows Assisted Living Community in Sherman at 3410 Post Oak Crossing in Sherman. See page 3 for directions.

We will have a called business meeting to vote if we want to keep meeting at this facility or return to

Map to the Willows Assisted Living Community 3410 Post Oak Crossing Sherman, Texas

Our March meeting will be held at The Willows Assisted Living Community located at 3410 Post Oak Crossing in Sherman. It is just off the south service road of Hwy 82 West. If you are coming from the south on Hwy 75, take exit 63 (hwy 82 west). Follow Hwy 82 west for less than a mile and take exit 640 (FM 1417). At signal light at 1417 turn south and then east at the signal light on to the south service road. Go about .3 mile, turn right (south) on Post Oak Crossing. There is parking on the east side (main entrance) and north side of the building. We will be using the dining room and it is straight ahead after you enter the front door.

If you are coming from the north on Hwy 75 take exit 63 to get on to Hwy 82 west. Once on 82, follow the above directions.

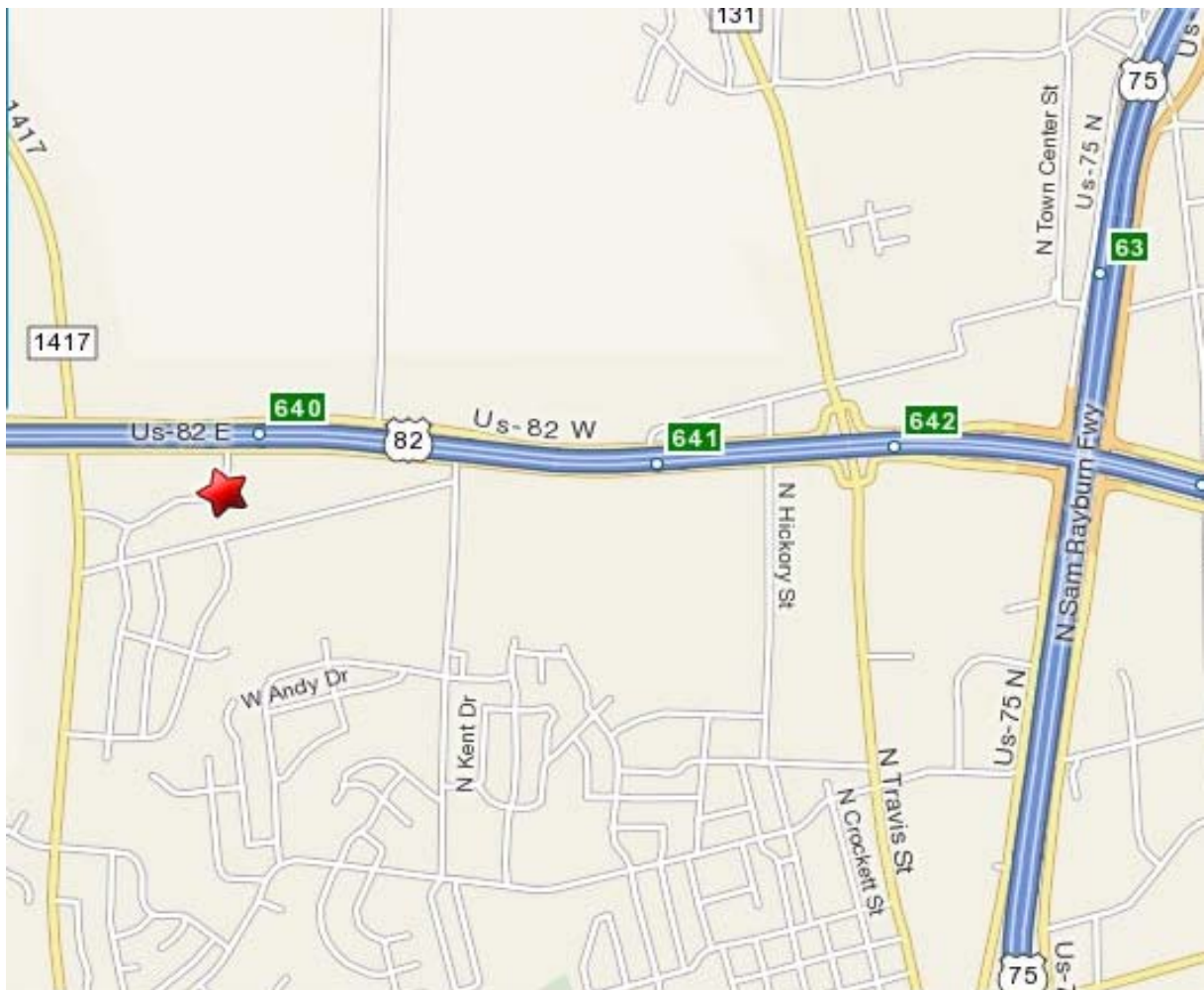

Minutes February 9, 2010

The meeting was called to order by president Sharon Mayo. There were 18 members in attendance. Sharon presented the budget to the chapter. It was recommended to change the Sunshine budget to \$100.00. Ann Keeling made the motion for change and it was second by Nancy Ness. Chapter voted and it was passed. Lisa Thornhill made the motion to pass the budget as it was presented, second by Carol Reichelt. Voted and passed.

Patricia Hamilton gave the year-end report to National which was the following:

\$4927.74	Balance
6365.74	received
11,301.51	Total
6650.80	spent

Nancy Nass discussed a \$1000.00 seminar.

Ann Keeling reported on a new meeting place at the Willows on Hwy 82. We would meet in their dining room. They will provide coffee and tea and there will be no charge. Patricia made the motion that we meet there in March and see if we like it. Second by Lisa Thornhill. Motion carried.

Doris Berry said 22 had signed up for the seminar with Ginger Edwards in March. She had 3 openings left. Seminar will be at the Life Specialty Hospital.

Doris will be painting on checkbook covers in May. Lisa Thornhill is doing the paint-in in March on Snow Mitten ornaments.

Meeting was adjourned by Sharon

Minutes March 3, 2010

Meeting was called to order by President Sharon Mayo. We had 18 members present.

Sandy Boling requested pictures of the Chapter for the scrapbook. Carol Reichelt needs small items for the give-away bags. Nancy Nass still needs pictures for the Membership books. She will have them ready to distribute next month. Rita Williams discussed the Memory Boxes for service project. She will distribute boxes next month. Ann Keeling reminded everyone about notifying her about any illnesses or deaths in the Chapter.

Ways and Means told the Chapter about the Mystery Paint-in in August. There will be 3 projects cost is \$20.00 per person. Bring your basic paint supplies on August 28th. Needs an enrollment of at least 15 people. Money is due by July.

Craft Fair at the Howe High School in November was discussed and all of the money will go to the Chapter. Each member is asked to paint at least 5 items with Chapter furnishing the material. Meeting in May we will start to work on some of the projects.

Tickets were given to members for the Spring Raffle. Drawing will be in May for 1 night in a condo at Tanglewood and dinner for 2.

Janice Marshall needs old wooden fencing and a cow utter.

Rita Williams will run the Chapter's Booth at National as a fund raiser. The Chapter will sell the rest of the charm holders, cell phone holders, chocolates and jewelry.

The treasurer's report was read and approved.

Meeting adjourned.

Workshops and Paint ins

Volunteers are still needed for June, July, September, and November. Please contact Suzanne Brooks if you would like to volunteer.

March-Lisa Thornhill

April-Doris Berry

May - Nancy Nass

June

July

August - Mystery paint in

September

October - Memory boxes

November

April Paint In

Angels Keep Me Balanced Checkbook Insert

taught by Doris Berry

I will have available for class the Roc Lon material cut and ready to be based as well as the clear check book covers for \$2.00 for the set. If you would like to furnish your own material, you can find the Roc Lon material at JoAnn's. There are two weights and I used the lighter weight for this project. You may also use canvas paper, but it is not quite as flexible as the Roc Lon.

Cut your project 6 1/4" X 6 1/4"

Supplies needed:

Ultra fine black Sharpie pen

Deco Art paint or colors of your choice

Bleached sand

Warm white

Victorian blue

Winter blue

Payne's gray

Tompte red

Fawn

Chapter Website

Always check the chapter website for chapter news.

wildflowersoftexaomachapter.com

The Wildflowers Website is for you, the members. If you would like to see anything else on the site please let me know and I will see if it can be added. Also send pictures..chapter activities or just something you have painted, an award you have received, if you have been published, etc. for the Atta Girl page. Also, if you see any errors, broken links, etc. let me know that also.

Nancy

ngenetti@tx.rr.com

Bring to the Meeting:

- *Yourself*
- *Acrylic painting supplies*
- *Info and pictures for website, newsletter, and historian.*

April Paint In continued:

Flesh

Shading flesh

Terra cotta

Burnt umber

Usual paint brushes

Doris 972-382-2170

Dberry72@hotmail.com



6 1/4" Wide

6 1/2" Length



Ways and Means

Mystery Day

- Saturday, August 23 - 9AM to 4PM
- 3 Projects/3 teachers - Approximately 2 hours each (should be able to complete each project before the end of the day)
- \$20 per participant
- Registration deadline is July 13, 2010
- We must have a commitment from at least 15 to schedule with money turned in no later than the July 13 meeting
- Committee will prep surfaces if needed and provide paint
- Participants will bring basic painting supplies
- HAVE FUN!!!!

Craft Fair

- Howe Band Booster Craft Show Saturday, November 13 at Howe High School
- All profits will go to chapter
- Cost of booth is \$60
- Most items will range from \$3 - \$10
- Have approximately 10 of each item (smaller things could be more than 10 and larger things less than 10)
- Objective is to have all members involved in making things for sale
- Format: Devote at least one meeting (maybe 2) to work on projects
 - At meeting have teams of 3-4 people working on one project with goal of completing 10 of each project
 - Example: if there are 20 members present we could work on 4 or 5 different projects
 - One completed project will be provided for each team, with written directions if necessary
- If you have ideas for projects, please let Nancy Nass know. We want as many members as possible involved in the success of this endeavor
- I would also encourage each person, during the year, to make 5 or 6 items of one project to also be included in the fair
- If we could have 150 items to sell, average \$4 per item, that \$600. What a success it would be.
- The show averages an attendance of over 1500 each year. This is a great opportunity to show who we are and what we do.

Raffle

Our Spring raffle will be a bit different this year. Renee Wade has very graciously offered a one night stay at a Tanglewood condo. The condo has all the amenities of home, including a Jacuzzi tub. The winner will also receive a \$50 Tanglewood gift card to be spent for anything that Tanglewood offers, (i.e. restaurant, club, golf, fishing, apparel). The stay can be used anytime and the certificate can be spent anytime. If you have not received tickets to sell, contact Nancy Nass. The drawing will take place at the May meeting.

Ginger Edwards seminar March 19, 20



Thanks Rita for taking the group picture.



Wasn't Ginger great with the individual help with everyone's Roses?

2010 Conventions

May 17-22 –SDP Conference, Wichita
May 17—SDP Opening Party Sock Hop
July 20-24—Art Expo, Houston
Aug 9-15—Hoot, Ohio
Sept 22-28—Seattle Mini Convention, Washington
Sept 22-25—Tole Country, Oklahoma
Oct 6-10— New England Traditions, Rhode Island

To view classes for Tole Country 2010

<http://tolecountry.org/conv/>



I wonder what Nancy was thinking about.

2009 Board of Directors

Elected officers:

President - Sharon Mayo
903-868-1876
s.mayo10@yahoo.com

1st VP (Seminars) - Doris Berry
972-382-2170
Dberry72@hotmail.com

2nd VP (Programs) - Suzanne Brooks
903-546-0086
ssbrooks1@verizon.net

Secretary - Cloris Martin
903-893-5468
barnclo@texoma.net

Treasure - Renee' Wade
903-892-0778
Bird2b@cableone.net

Past President - Rita Williams
903-465-8764
rmwiltx@yahoo.com

Committee chairpersons:

Historian - Sandi Boling
903-815-6304
seboling@cableone.net

Hospitality - Carol Reichelt
903-892-9592
Rodcar1102@aol.com

Membership - Nancy Nass
903-532-6548
nass@cableone.net

Newsletter - Patricia Hamilton
903-546-6464
plhamilton@cableone.net

Parliamentarian - J'net Chambers
214-544-0340
Jnet1957@aol.com

Publicity - Millie Payne
903-465-2675
mpayne@heralddemocrat.com

Service Projects - Rita Williams
903-465-8764
rmwiltx@yahoo.com

Sunshine - Ann Keeling
903-870-1174
annK92@yahoo.com

Ways and Means - Janice Marshall
903-465-8934
tolegranny@cableone.net



**Painting—the real
therapy!**

Calendar of Interest to Wildflower Members

2010

April 16-18—Yellow Rose - Sharon Hamilton
October 15-17—Yellow rose - Bob
Pennycook
October 28, 29, 30—Bluebonnet—Vickie
Rhodes

2011

March 31, April 1,2—Bluebonnet—Ros Stallcup